



# Gemini<sup>®</sup> XL Convertible Hand Truck Owners Manual



## Table of Contents

Introduction, General Safety Instructions .....	3
Gemini Specifications .....	4
Gemini Operation .....	5
Converting Gemini Between 2- and 4-wheel Positions .....	6
Troubleshooting .....	7
Gemini Part Diagrams .....	8-9
Inspection / Maintenance Checklist .....	10

**Thank you for using the Magliner Gemini® XL Convertible Hand Truck.** Please read this manual thoroughly to become familiar with the safe operation and maintenance of the Gemini Convertible Hand Truck.

## General Safety Instructions

- Before using your Gemini:
  - Carefully read this entire manual
  - Check tires for wear
  - Tighten fasteners
  - Check for bent or broken parts
  - If you see a Gemini in need of repair, replace damaged parts immediately. Never use a Gemini that is not in proper working order. If you use a broken Gemini, you risk damaging the delivery and more importantly you risk injuring yourself.
- Using your Gemini:
  - Do not exceed the weight capacity limit for the Gemini as specified in this manual
  - Operator should be positioned uphill from Gemini when descending on natural grades, sloping or uneven surfaces
  - Avoid making sharp turns when pushing Gemini
  - Keep your eyes on the path
- Loading the Gemini:
  - Using proper alignment, lift with your legs, not your back
  - Head up, back straight
  - Never twist with your back - turn with your feet
  - When loading the Gemini, a balanced, stable load is best
  - Your load should never block your vision
  - Don't overload - two trips are safer than one
- At the delivery:
  - Walk your path looking for obstructions, cracks, holes and uneven surfaces
  - Look for any vehicle or foot traffic
  - Note blind corners, doors and curbs
  - Take time to walk the delivery path. Be prepared for areas that could pose a problem while you deliver and try to avoid them altogether, even if it means a few extra steps.
- Gemini storage:
  - Never leave the Gemini unattended in an aisle
  - Always secure the Gemini in back of truck before driving to next location

**Use the Gemini only as specified in this manual**

## Gemini Convertible Hand Truck Specifications

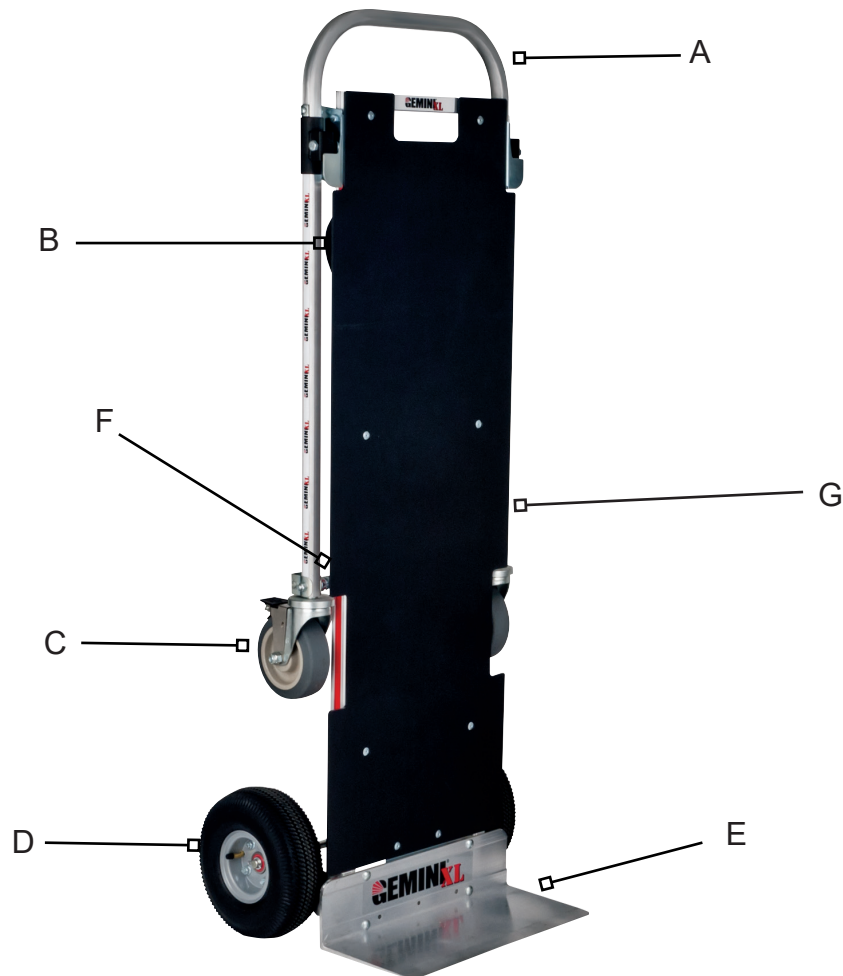

### Gemini Components

- A. Upper handle (sometimes referred to as the “B-handle”) for ergonomic hand/shoulder placement during pushing
- B. Lower horizontal loop handle for maneuvering in the 2-wheel position
- C. 6” x 2” swivel casters with parking brake (to be used on level surfaces only)
- D. 10” 4-ply tube type pneumatic wheels offer excellent shock absorption and starting roll-force
- E. Wide extruded aluminum nose carries a wide variety of products
- F. Latch and lock mechanism securely locks Gemini in the 2-wheel position
- G. Solid deck prevents smaller items from falling through the frame

### Gemini Capacity and Gemini Weight

The Gemini can be used in the 2-wheel position and in 4-wheel position. The Gemini capacity in the 2-wheel position is 500 lbs.; Gemini capacity in the 4-wheel position is 1,250 lbs.

The Gemini XL weighs 54 lbs.

## Delivery Gemini Operation

### When do I use in 2-wheel position?

Although the Gemini can be used for many different load variations, typical 2-wheel delivery scenarios may include the following (500 lbs. maximum):

- When mixed items are delivered to the same location
- For deliveries where it is necessary to transport a mix of up to:
  - Limited space deliveries
  - Frequent stairwells and curbs
  - Busy freight elevator usage
  - High density of pedestrians
  - For deliveries weighing no more than 500 lbs.



### When do I use in 4-wheel position?

Although the Gemini can be used for many different load variations, typical 4-wheel delivery scenarios may include the following (1,250 lbs. maximum, DO NOT use on stairwells in the 4-wheel position):

- When mixed items are delivered to the same location
- For deliveries weighing up to 1,250 lbs.
- Delivery area is free of steps, curbs, etc.



## Converting Gemini Between 2- and 4-wheel Positions

Note: Be sure to allow adequate room on a flat, clear surface for converting the truck between 2- and 4-wheel positions. **Caution: While converting the Gemini between the 2- and 4-wheel positions, take care to keep hands out of the way of moving parts.**

### *From 2-wheel to 4-wheel:*

1. Hold the Gemini securely with one hand on upper handle and the other hand on the top frame cross member; press release latch (see Figure 1)
2. Keeping the upper handle as perpendicular to the ground as possible, slide the frame down the upper handle until the handle plate rests on the spreader rod (see Figures 2 and 3).
3. You are now ready to use the Gemini in the 4-wheel position



Figure 1



Figure 2



Figure 3

### *From 4-wheel to 2-wheel:*

1. Place one hand securely on the upper handle and the other hand on the top frame cross member
2. Keeping the upper handle as perpendicular to the ground as possible, begin to slide the frame up the upper handle (see Figure 5). Continue lifting the frame to the top of the upper handle as you orient the frame so that it becomes perpendicular to the ground (see Figures 5 and 6).
3. With the Gemini wheels and nose resting squarely on the ground, swing the bottom of the upper handle toward the Gemini frame so that the spreader rod locks firmly in place with the latch/lock assembly (see Figure 6)
4. You are now ready to use the Gemini in the 2-wheel position



Figure 4



Figure 5



Figure 6

## Troubleshooting

The Gemini XL is difficult to transition between 2- and 4-wheel positions.

- ✓ Is the upper handle bent to where it should be replaced?
- ✓ Are there burrs or other damage on the upper handle? File or sand smooth, or replace the handle.
- ✓ Are the pivot sockets damaged or bent and should be replaced?
- ✓ Replace worn, damaged or missing components.

The Gemini XL frame will not latch when in the 2-wheel position.

- ✓ Are the latch components in place and in good condition?
- ✓ Is the latch rod in place and in good condition?
- ✓ Are latch component mounting screws loose? Tighten mounting screws.
- ✓ Replace worn, damaged or missing components.

The Gemini XL does not roll smoothly.

- ✓ Are the main wheels loose?
- ✓ Are the caster brakes applied?
- ✓ Are the bearings in the main wheels free and in good working order?
- ✓ Are the brackets on the casters bent or broken?
- ✓ Do the casters swivel easily?
- ✓ Are there flat spots on the main wheels or caster wheels?
- ✓ Replace worn, damaged or missing components.

# GEMINI® CONVERTIBLE HAND TRUCK PART DIAGRAMS

## XLSP/XLAP

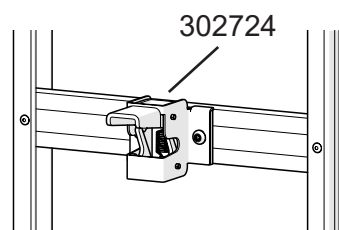
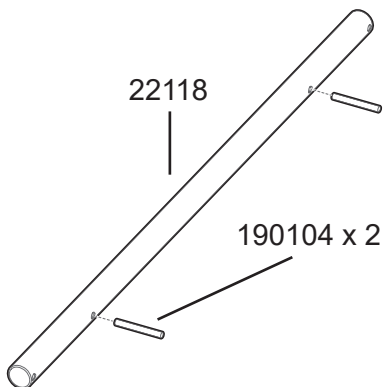
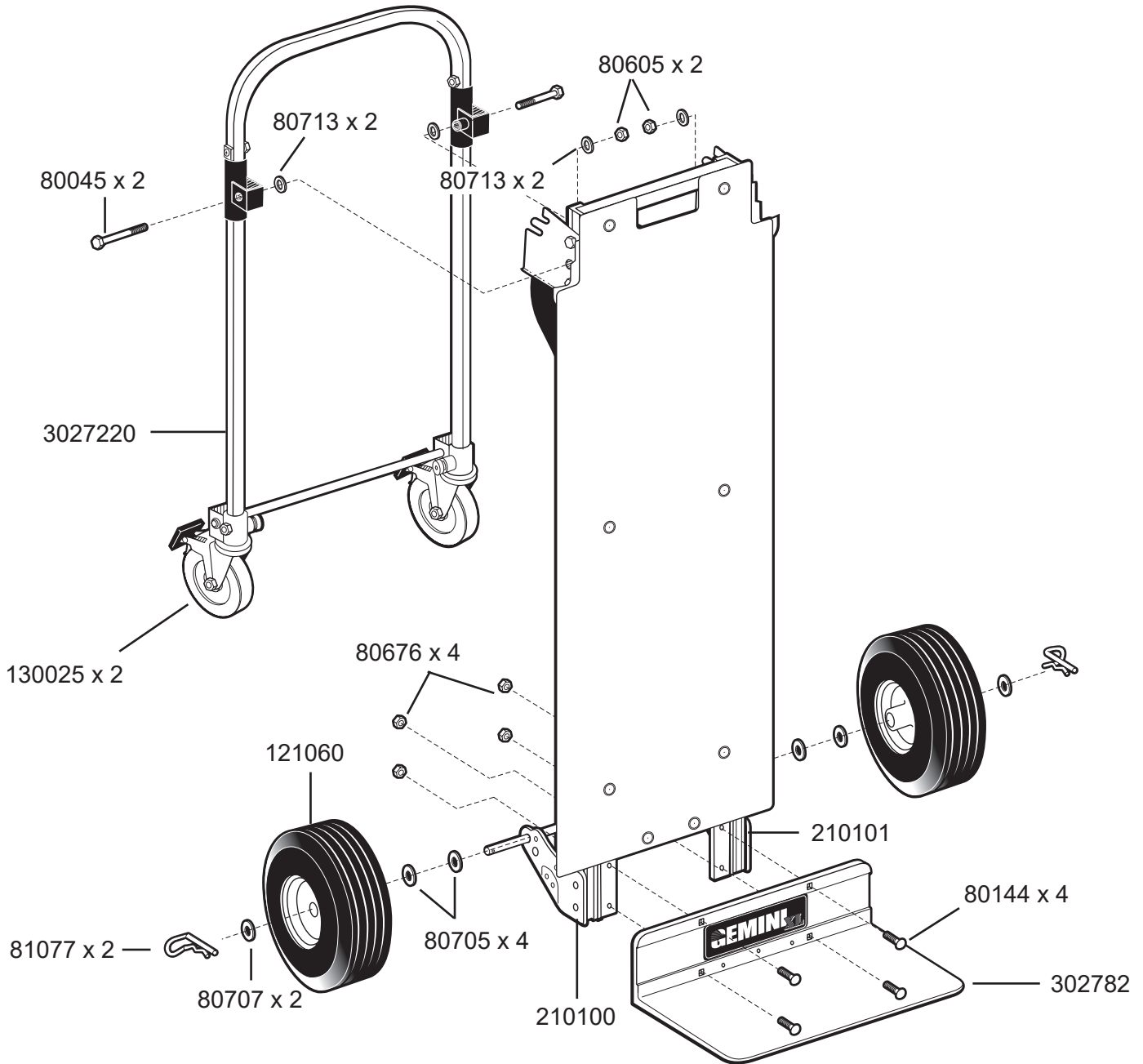



Part Description	Part Number
Handle assembly	3027220
Caster - 6" x 2" with brake	130025
Extruded aluminum nose - 18" wide	302782
Wheel - 10" 4-ply tube type pneumatic	121060
Latch and lock assembly for Gemini XL	302724
Axle - 20" long	22118
Axle roll pin - 1/8" x 1-1/8" long	190104
Hex head cap screw - 7/16"-14 x 3-3/4" long	80045
Flat washer - 7/16"	80713
Lock nut - 7/16"-14	80605
Carriage bolt - 5/16"-18 x 1" long	80144
Lock nut - 5/16"-18	80676
Washer - 5/8" x 3/32" (thick)	80705
Washer - 5/8" x 1/32" (thin)	80707
Cotter pin for axle - 1/8" x 1" long	81077
No. 19 standard U-loop with vinyl sleeve	301008
Handle mounting bolt - 1/4"-20 x 2-1/2" long	80108
Lock nut - 1/4"-20	80675
Wheel bracket - RH	210100
Wheel bracket - LH	210101

### TOOLS REQUIRED

- (1) #3 PHILLIPS SCREWDRIVER
- (1) 7/16" COMBINATION WRENCH
- (1) 1/2" COMBINATION WRENCH
- (2) 5/8" COMBINATION WRENCH OR SOCKET
- (1) NEEDLE NOSE PLIERS
- (1) HAMMER

Inspection Date: \_\_\_\_\_ Customer Location: \_\_\_\_\_

Inspector's Name: \_\_\_\_\_



Area	Description	Method of Inspection	Normal Condition	Findings Pass or Fail	Timing	Notes
General Inspection	Gemini is straight and properly aligned	Visual inspection	<ul style="list-style-type: none"> <li>Frame is not twisted or bent</li> <li>Latch and lock assembly is not bent or damaged</li> <li>Upper handle is not bent or damaged</li> </ul>		Daily	
General Inspection	Gemini shows no damage or excessive wear	Visual inspection	<ul style="list-style-type: none"> <li>Straight sections</li> <li>Smooth curves</li> <li>Flat surfaces</li> </ul>		Daily	
General Inspection	Gemini folds and unfolds properly	Follow conversion steps to fold and unfold Gemini	Gemini should easily convert from 2- to 4-wheel position (some lubrication may be required over time)		Daily	
General Inspection	Gemini wheels, casters and caster brakes are in good condition	Visual inspection	<ul style="list-style-type: none"> <li>There should be no chunks missing from the wheel material</li> <li>The hub is not cracked or damaged</li> <li>No missing cotter pins</li> </ul>		Daily	
General Inspection	Fasteners	Visual inspection	<ul style="list-style-type: none"> <li>No loose fasteners</li> <li>No missing fasteners</li> </ul>		Daily	

**Magline, Inc.**

1205 W. Cedar Street • Standish, MI 48658 USA  
 1-800-MAGLINE (624-5463) • (989) 512-1000 (outside U.S. & Canada)  
[www.magliner.com](http://www.magliner.com)

Form # B9596

© Copyright 2021, Magline, Inc.