

HEAVY DUTY PRECISION TURRET BEARING - PTB-19

APPROX WEIGHT: 98 LBS
 DOES NOT INCLUDE WEIGHT OF POWER OR PACKAGING!!!

ANY ADDITIONS, DELETIONS, OR OMISSIONS MUST BE CORRECTED ON THIS DRAWING AS THIS DRAWING WILL BE CONSIDERED ALL INCLUSIVE

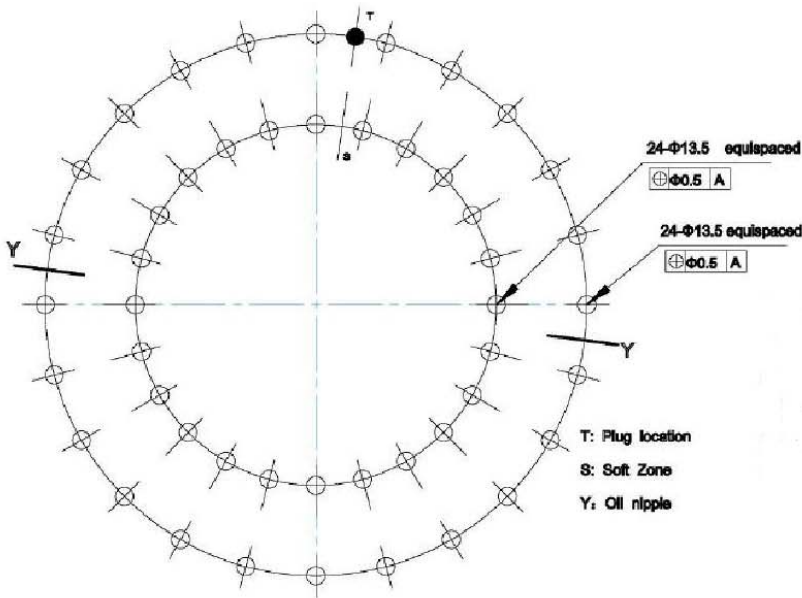
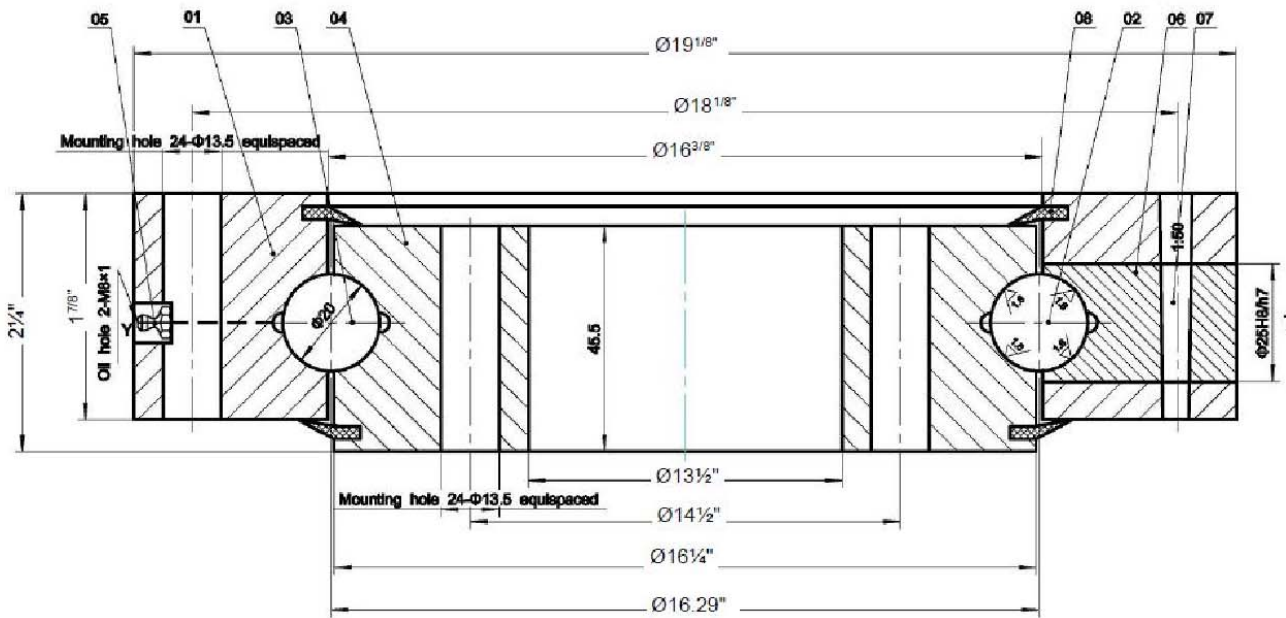

FOR INTERNAL USE ONLY PROJECT SIGN OFF	
SALES	
ENG.	
FAB.	
POWER	

ALL GRAPHICS PROVIDED ARE FOR REFERENCE ONLY.
 IF CERTAIN DIMENSIONS ARE CRITICAL PLEASE VERIFY
 THOSE DIMENSIONS WITH YOUR SALESPERSON

STANDARD FEATURES

MODEL# PTB-19
 DIAMETER: 19 1/8"
 HEIGHT: 2 1/4"
 CAPACITY: 6000 LBS
 LOW PROFILE DESIGN

SUPERIOR PLATED FINISH FOR CORROSION RESISTANCE

GREASE-ABLE POINTS FOR SIMPLE MAINTENANCE

SHIELDED BEARINGS TO PROTECT DEBRIS AND
 RETAIN GREASE

MULTIPLE BOLT LOCATIONS FOR MOUNTING

CAPTURED BALL BEARING DESIGN PREVENTS RINGS
 FROM SEPARATING

APPROVAL	I, THE UNDERSIGNED, AGREE THAT THE PRODUCT AS REPRESENTED SATISFIES DESIGN AND DIMENSION REQUIREMENTS. I ALSO ACKNOWLEDGE MY DUTY TO CONFIRM PRODUCT AND INSTALLATION COMPLIANCE WITH ALL APPLICABLE FEDERAL, STATE AND LOCAL REGULATIONS AND STANDARDS.	
	ANY MODIFIED UNITS ARE NON-RETURNABLE	
	[] As drawn [] As marked	
	Signed: _____	Date: _____
Printed Name: _____		
<i>LEAD TIME WILL START UPON RECEIPT OF SIGNED APPROVAL DRAWING</i>		

DISTRIBUTOR'S NAME:		P.O.#
VESTIL MANUFACTURING		X
		W.O.#
DRAWN BY: X		X
DATE: XX/XX/XX		SALES: X
REFERENCE: X	SCALE: 1:1	FILE NAME:
QUOTED LEAD TIME: X	QUOTE #	PTB-19
	X	