



Vestil Manufacturing Corp.
 2999 North Wayne Street, P.O. Box 507, Angola, IN 46703
 Telephone: (260) 665-7586 -or- Toll Free (800) 348-0868
 Fax: (260) 665-1339
 Website: www.vestilmfg.com e-mail: info@vestil.com

Lifter-2 Worksite Lift Instruction Manual



Receiving instructions:

After delivery, remove the packaging from the product. Inspect the product closely to determine whether it sustained damage during transport. If damage is discovered, record a complete description of it on the bill of lading. If the product is undamaged, discard the packaging.

NOTE:

The end-user is solely responsible for confirming that product design, installation, use, and maintenance comply with laws, regulations, codes, and mandatory standards applied where the product is used.

Table of Contents

Signal Words.....	2
Hazards of Improper Use.....	2
Assembly and use Instructions.....	3
Loading the lifter.....	4
Inspections & Maintenance.....	4
Exploded Parts Diagram and Bill of Materials.....	5
Label placement diagram	6
Limited warranty.....	7

Signal Words:

This manual uses SIGNAL WORDS to direct the reader's attention to statements about uses of the product that could result in personal injury or property damage. Each signal word correlates with a specific level of seriousness.



Identifies a hazardous situation which, if not avoided, **WILL** result in **DEATH** or **SERIOUS INJURY**. Use of this signal word is limited to the most extreme situations.



Identifies a hazardous situation which, if not avoided, **COULD** result in **DEATH** or **SERIOUS INJURY**.



Indicates a hazardous situation which, if not avoided, **COULD** result in **MINOR** or **MODERATE** injury.



Identifies practices likely to result in product/property damage, such as operation that might damage the product.

Hazards of Improper Use:

Vestil strives to identify all hazards associated with the use of this product. However, material handling is dangerous and no manual can address every conceivable risk. The most effective means for preventing injury is for the end-user to exercise good judgment whenever using this device.



If this product is used improperly or carelessly, the operator and/or bystanders might sustain serious personal injuries or even be killed. To reduce the likelihood of injury:

• **Read this manual in its entirety. Failure to read and understand the entire manual before assembling, installing, using or servicing the product is a misuse of the product.**

- Read the manual to refresh your understanding of proper use and maintenance procedures.
- DO NOT attempt to resolve any problem(s) with the product unless you are both authorized to do so and certain that it will be safe to use afterwards.
- DO NOT modify the product in any way UNLESS you first obtain written approval from Vestil. Unauthorized modifications automatically void the Limited Warranty and might make the product unsafe to use.
- DO NOT exceed the maximum rated load (see Label 287 on product).
- Inspect the product as described in "Inspections and Maintenance" on p. 4.
- BEFORE operating, inspect mast, carriage, forks/deck, cable/chain, wheels, and brakes for damage. DO NOT use if damaged.
- ALWAYS walk travel path before using truck to identify hazards:
- DO NOT contact electrical lines or overhead objects with device or load;
- DO NOT travel up/down inclines if an alternate route is available;
- DO NOT travel over debris.
- ONLY travel with forks/deck in lowest position appropriate for conditions.
- ALWAYS center and evenly distribute loads on forks/deck.
- ALWAYS secure load to forks/deck.
- ONLY drive or operate truck functions from operator position.
- DO NOT exceed maximum rated load (capacity).
- DO NOT allow people to ride on device.
- DO NOT lift loads over people; DO NOT permit people to walk beneath the forks/deck when raised (loaded or unloaded).
- DO NOT leave unattended UNTIL fully lowered AND unloaded.
- DO NOT modify device in any way.

Assembly Instructions:

The Lifter-2 ships in fully assembled form. However, the lifter can easily be disassembled. Refer to the exploded parts diagram and bill of materials on p. 3, and then:

1. Disconnect the hook (on the winch cable) from the deck (5);
2. Remove the upright (2) from the base (1). Loosen the 4-handle bolt (18) and then lift the upright out of the opening in the base.
3. Unfasten the jib (26) from the upright (2). The jib fastens to the upright by means of two clevis pins (10). Pull the cotter pins (12) out of the clevis pins; then remove the clevis pins and separate the jib and the upright. [NOTE: Reinstall the clevis pins in the bracket at the top of the upright and reinstall the clevis pins to prevent the pins from being lost.]
4. Unpin the legs. Remove the (four) outer clevis pins that fasten the legs (3 & 4) to the base. Each pin is secured in place with a hitch pin underneath the base. Each leg should still be fastened to the base.
5. Store the disassembled lifter in a location where it will remain dry.

Use Instructions:

The lifter can be used in either of 2 configurations.

1. Hoist with a stationary deck:
2. Winch connected to the deck: lifter to function as a manually-propelled high lift truck.

Configuration #1: Pulley pinned to end of jib with deck resting on base

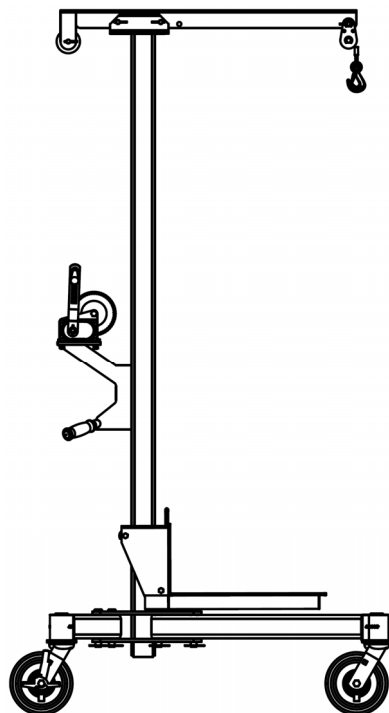

Configuration #2: Pulley pinned to jib above deck with winch hook attached to deck lifting eye.

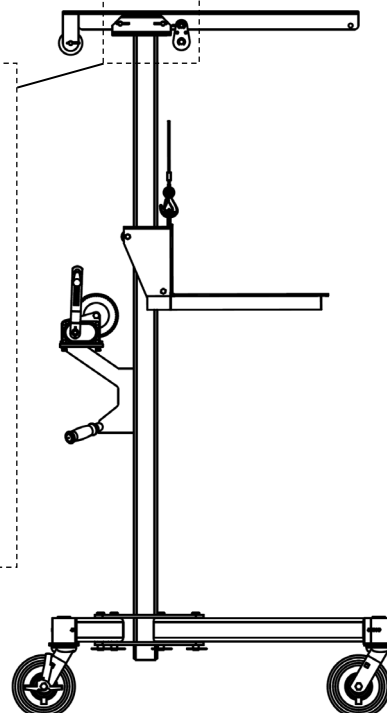

To change the location of the pulley, pull the cotter pin out of the pulley clevis pin and remove the pulley clevis pin; then pin the pulley in the necessary position on the jib.

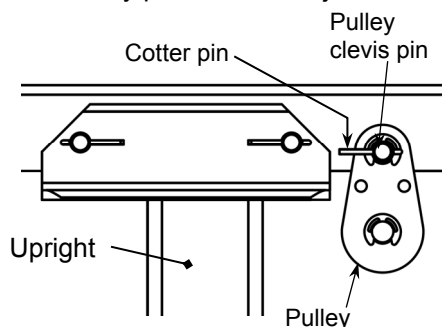

Loading the lifter:

Configuration 1: Attach a load to the hook using proper hoisting practices. Raise the load sufficiently to be able to rest it on the deck. The load should be stable, centered, and evenly-distributed on the deck.

Configuration 2: Fully lower the deck, if necessary and then set the load on the deck. Be sure to center and evenly-distribute the load on the deck. Transport the load with the deck lowered.

Deck dimensions	Overall dimensions	Service range of deck	Service range of boom	Boom reach	Net weight
20" x 20" 51cm x 51cm	36 ¹ / ₂ " x 48 ¹ / ₂ " x 90 ⁹ / ₁₆ " 92.7cm x 123.2cm x 230cm	14 ³ / ₄ " to 70" 37 ¹ / ₂ cm to 178cm	0" to 80" 0cm to 203.2cm	25 ¹ / ₁₆ " 63.7cm	388" 176.4 kg

Uniform capacity = 500 lb. (227.3 kg)

Deck capacity = 500 lb. (227.3 kg)

Winch capacity = 500 lb. (227.3 kg)

Inspections and Maintenance:

Regular inspections and maintenance are necessary to keep the device in normal condition. Before using the lifter for the first time, create a written record that describes its appearance and functions. The record should include detailed descriptions about the shape and condition of the retaining frame members, casters, boom, deck, and the lifting mechanisms (winch, cable, pulleys). Raise and lower the deck. Include observations about how the deck moves up and down the mast as well as sounds produced as the deck moves. This written record establishes "normal condition". When conducting future inspections, compare those observations with the written record to determine if a component requires repair or replacement.

Before using the lifter for the first time and at least once every 2 weeks, visually inspect the following components:

1. Cable: look for areas that are fraying or severely damaged. For example, look for regions where the cable diameter is markedly reduced.
2. Frame (boom, mast, base, deck): examine the frame members for damaged welds, severe rusting, cracks, warps, etc.
3. Winch and pulleys: cycle the deck up and down. Watch the deck to make sure that it moves smoothly. Listen for unusual noises and watch for binding or rough movement as the deck moves.
4. Casters: check each caster for excessive wear.
5. Hardware: examine the pins, bolts, nuts, etc. Tighten loose fasteners.
6. Hook: check the hook and the safety latch. Confirm that the throat opening is not widening. The hook should not be cracked, twisted or distorted.

Maintenance: Implement a maintenance program to ensure that the lifter functions properly. Page 9 of ANSI/ITSDF standard B56.10-2006, "Manually propelled high lift industrial trucks", describes recommended maintenance procedures. A copy of the standard is downloadable for free from the ITSDF website (see www.itsdf.org). Apply those recommendations in conjunction with the following steps.

Step 1: Tag the lifter, "Out of Service."

Step 2: Inspect the lifter as described above. If deformity, corrosion, rusting, or excessive wear of structural members is present, DO NOT use the lifter. If the deck does not move smoothly or makes noise as it moves up or down the upright, apply a silicon wax or silicon spray to the inside of the mast frame.

Step 3: Remove any dirt or other matter from the cable and pulleys and other lifter surfaces.

Step 4: Perform all other necessary adjustments and/or repairs. DO NOT modify the lifter.

Step 5: Make a dated record of the repairs, adjustments and/or replacements made.

Exploded Parts Diagram and Bill of Materials

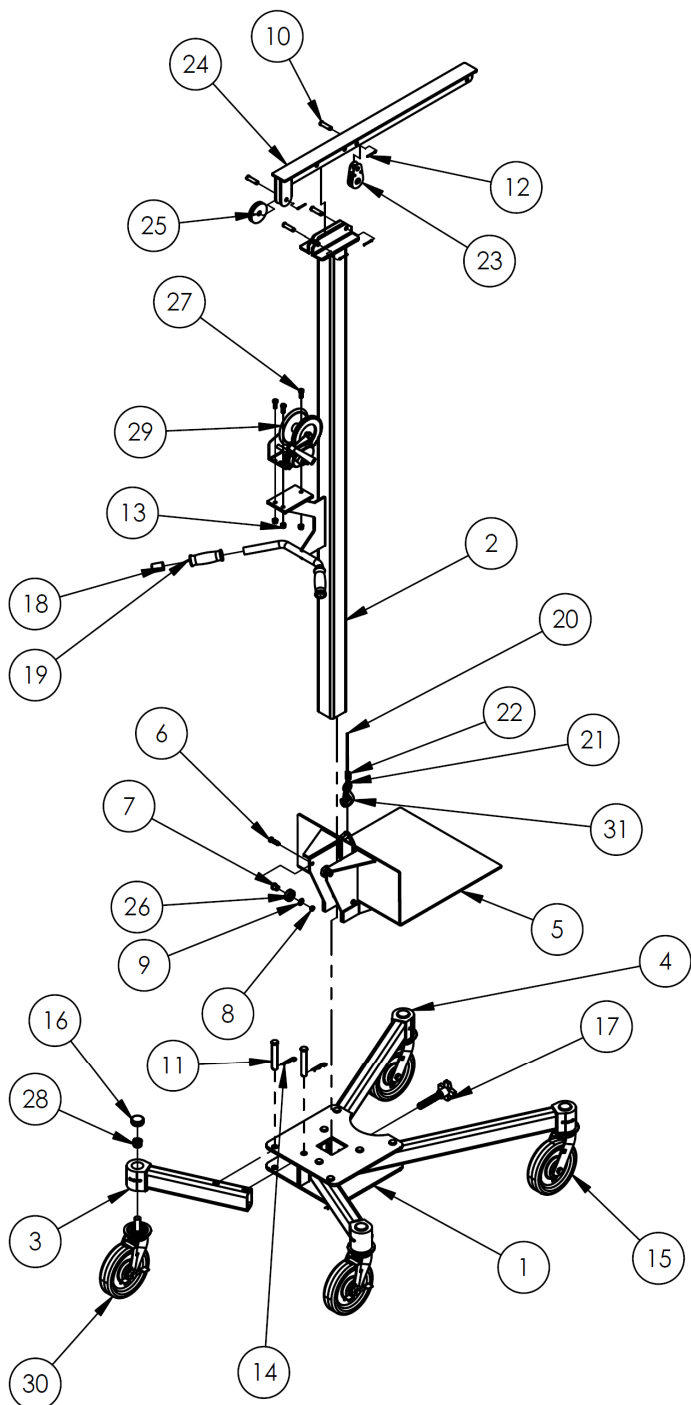

Item	Part no.	Description	Qty.
1	42-514-022	Weldment, base	1
2	42-514-023	Weldment, upright	1
3	42-514-025	Weldment, frame leg, back	2
4	42-514-024	Weldment, frame leg, front	2
5	42-513-009	Weldment, deck	1
6	11108	³ / ₈ " - 16 x 1 ³ / ₈ " zinc-plated hex cap screw	4
7	21-113-021	Spacer, bearing shaft	4
8	37026	³ / ₈ " - 16 zinc-plated jam lock nut	4
9	68083	Steel e-clip for ⁵ / ₈ " shaft	4
10	21-112-003	¹ / ₂ " x 1 ¹⁵ / ₁₆ " retaining clevis pin	4
11	28-112-031	³ / ₄ " x 4 ¹ / ₂ " clevis pin	8
12	65078	¹ / ₈ " x 1 ¹ / ₂ " zinc-plated cotter pin	4
13	37024	³ / ₈ " nylock insert nut	3
14	45283	#7 hitch pin clip	8
15	16-132-181	PH-8/2-RB-S-SB stem caster	2
16	99-024-003	Guard, cover, endcap. plug	4
17	08-025-008	4" 4-handle bolt	1
18	21-024-038	Handle grip, rubber end cap	2
19	15-025-006	Grip, handle	2
20	42-145-004	³ / ₁₆ " aircraft cable, 180" long	1
21	21-145-013	Thimbles, LLW	1
22	21-145-012	Cable anchor, LLW	1
23	28-027-004	Pulley, tear drop	1
24	42-516-004	Weldment, jib attachment, bracket	1
25	99-027-003	Assembly, pulley with bronze bushing	1
26	20-110-006	Roller bearing	4
27	11105	Hex bolt, grade A, zinc-plated, 3/8" - 16 x 1"	3
28	37039	³ / ₄ " - 10 zinc-plated lock nut	4
29	21-042-002-001	Hand winch, foldable handle grip	1
30	16-132-204	PH-F-8/2-S-SWB-ST stem caster	2
31	08-145-045	Clasp hook, ³ / ₄ " hook opening	1

Labeling Diagram:

The product should always be labeled as shown in the diagram below. Replace all labels that are faded, damaged, or not easily readable.

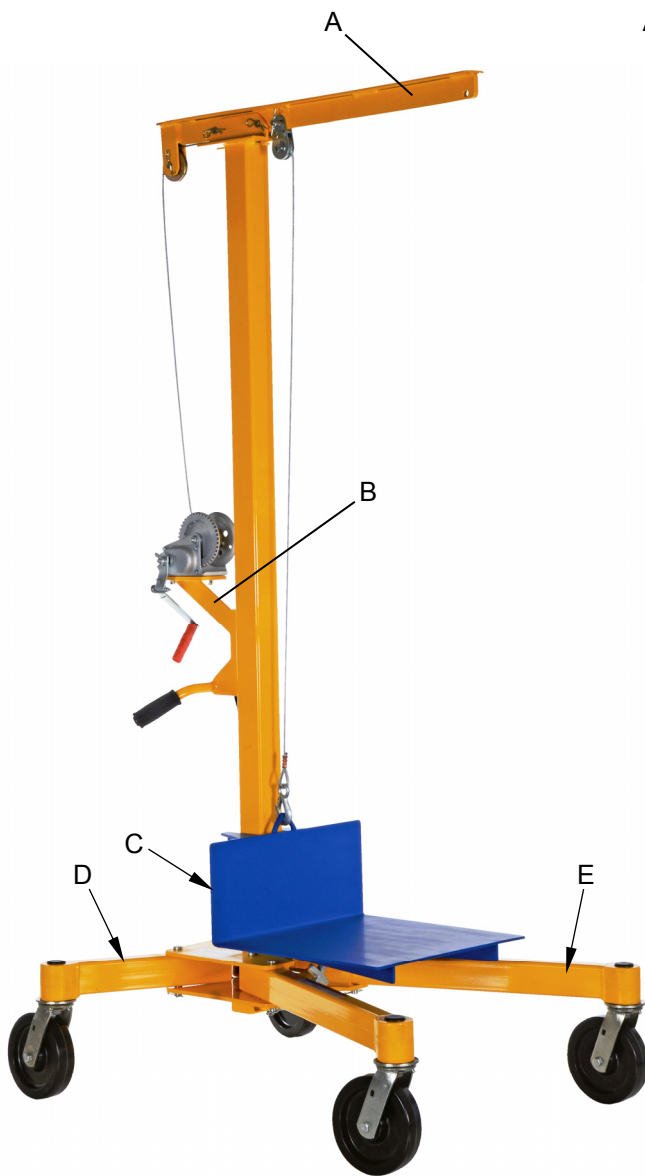

A: Label 598



B: Label 287

MODEL/MODÉLO/MODÈLE _____
STATIC CAPACITY (evenly distributed) _____ lbs.
LA CAPACIDAD CONSTANTE (distribuida uniformemente) _____ kgs.
CAPACITÉ STATIQUE (distribuée régulièrement) _____ kgs.
SERIAL/SERIE/SÉRIE _____

287 REV 0812

C: Label 527

⚠ WARNING
<p>Only trained, authorized persons should operate this device. Improper operation might result in serious personal injuries sustained by the truck operator and/or bystanders. Operators must observe the following safety-enhancing practices:</p> <ul style="list-style-type: none"> • BEFORE operating, inspect mast, carriage, forks/deck, cable/chain, wheels, and brakes for damage. DO NOT use if damaged. • ALWAYS walk travel path before using truck to identify hazards: <ul style="list-style-type: none"> 3 DO NOT contact electrical lines or overhead objects with device or load; 3 DO NOT travel up/down inclines if an alternate route is available; 3 DO NOT travel over debris. • ONLY travel with forks/deck in lowest position appropriate for conditions. • ALWAYS center and evenly distribute loads on forks/deck. • ALWAYS secure load to forks/deck. • ONLY drive or operate truck functions from operator position. • DO NOT exceed maximum rated load (capacity). • DO NOT allow people to ride on device. • DO NOT lift loads over people; DO NOT permit people to walk beneath the forks/deck when raised (loaded or unloaded). • DO NOT leave unattended UNTIL fully lowered AND unloaded. • DO NOT modify device in any way.
⚠ ADVERTENCIA
<p>Solo personas entrenadas y autorizadas deben operar este equipo. La operación inadecuada podría resultar en daños serios al operario del camión y/o a los transeuntes. Los operarios deben observar y seguir las siguientes prácticas de seguridad:</p> <ul style="list-style-type: none"> • ANTES de usar, inspeccione el mástil, el equipo, las horquillas/plataforma, cable/cadena, ruedas y frenos por daños. NO use si se observan daños. • SIEMPRE camine el trayecto de viaje antes de usar el camión para identificar riesgos: <ul style="list-style-type: none"> 3 NO toque las líneas eléctricas u objetos altos con el dispositivo o la carga; 3 NO viaje en inclinaciones de subida y bajada si hay otra ruta alternativa; 3 NO viaje sobre desechos. • SOLO viaje con las horquillas/plataforma en la posición de descenso más apropiada para las condiciones. • SIEMPRE centre y distribuya las cargas uniformemente en las horquillas/plataforma • SIEMPRE asegure la carga a las horquillas/plataforma. • SOLO conduzca u opere las funciones del camión desde la posición del operario. • NO exceda la capacidad máxima tasada de carga. • NO permita que la gente viaje en el equipo. • NO eleve las cargas sobre la gente; NO permita que la gente camine debajo de las horquillas/plataforma cuando este elevada (con carga o sin carga). • NO deje el equipo desatendido HASTA que este completamente cargado Y descargado. • NO modifique el equipo de ninguna manera.

527 • Rev 1109

D: Label 212

⚠ WARNING	⚠ ADVERTENCIA	⚠ AVERTISSEMENT
LOCK CASTER when loading and unloading	PONGA EL FREND O el la rueda cuando se cargue y descargue	VERROUILLER LA ROULETTE en chargeant et decharger
Vestil Manufacturing Corporation • Angola, Indiana USA • Phone (260) 665-7596 • www.vestil.com 212 Rev 0908		

E: Label 208

⚠ WARNING	⚠ ADVERTENCIA	⚠ AVERTISSEMENT
KEEP CLEAR OF PINCH POINT	MANTENGASE ALEJADO DEL PUNTO DE CORTE	SE TENIR À DISTANCE DU POINT DE PINCEMENT
208A		

LIMITED WARRANTY

Vestil Manufacturing Corporation (“Vestil”) warrants this product to be free of defects in material and workmanship during the warranty period. Our warranty obligation is to provide a replacement for a defective original part if the part is covered by the warranty, after we receive a proper request from the warrantee (you) for warranty service.

Who may request service?

Only a warrantee may request service. *You are a warrantee if* you purchased the product from Vestil or from an authorized distributor AND Vestil has been fully paid.

What is an “original part”?

An original part is a part used to make the product as shipped to the warrantee.

What is a “proper request”?

A request for warranty service is proper if Vestil receives: 1) a photocopy of the Customer Invoice that displays the shipping date; AND 2) a written request for warranty service including your name and phone number. Send requests by any of the following methods:

Mail
Vestil Manufacturing Corporation
2999 North Wayne Street, PO Box 507
Angola, IN 46703

Fax
(260) 665-1339
Phone
(260) 665-7586

Email
sales@vestil.com

In the written request, list the parts believed to be defective and include the address where replacements should be delivered.

What is covered under the warranty?

After Vestil receives your request for warranty service, an authorized representative will contact you to determine whether your claim is covered by the warranty. Before providing warranty service, Vestil may require you to send the entire product, or just the defective part or parts, to its facility in Angola, IN. The warranty covers defects in the following *original* dynamic components: motors, hydraulic pumps, electronic controllers, switches and cylinders. It also covers defects in *original* parts that wear under normal usage conditions (“wearing parts”): bearings, hoses, wheels, seals, brushes, batteries, and the battery charger.

How long is the warranty period?

The warranty period for original dynamic components is 90 days. For wearing parts, the warranty period is 90 days. The warranty periods begin on the date when Vestil ships the product to the warrantee. If the product was purchased from an authorized distributor, the periods begin when the distributor ships the product. Vestil may, at its sole discretion, extend the warranty periods for products shipped from authorized distributors by *up to* 30 days to account for shipping time.

If a defective part is covered by the warranty, what will Vestil do to correct the problem?

Vestil will provide an appropriate replacement for any *covered* part. An authorized representative of Vestil will contact you to discuss your claim.

What is not covered by the warranty?

1. Labor;
2. Freight;
3. Occurrence of any of the following, which automatically voids the warranty:
 - Product misuse;
 - Negligent operation or repair;
 - Corrosion or use in corrosive environments;
 - Inadequate or improper maintenance;
 - Damage sustained during shipping;
 - Collisions or other incidental contacts causing damage to the product;
 - Unauthorized modifications: DO NOT modify the product IN ANY WAY without first receiving written authorization from Vestil. Modification(s) might make the product unsafe to use or might cause excessive and/or abnormal wear.

Do any other warranties apply to the product?

Vestil Manufacturing Corp. makes no other express warranties. All implied warranties are disclaimed to the extent allowed by law. Any implied warranty not disclaimed is limited in scope to the terms of this Limited Warranty.

